



## **Forged Body Top Load Check Valve**

**Weir SPM offers its Forged Body Top Load Check Valve in 2" thru 4" in both conventional hammer union and Safety Iron™ connections.**



## Prevent back flow through the flow line with the Forged Body Top Load Check Valve.

Weir SPM's Clapper Style Check Valves are flow control devices placed in treating lines to allow flow to the well but isolate any back flow upstream of the valve. Weir SPM check valves are manufactured in 2", 3", and 4" sizes in both hammer union and Safety Iron™ end connections. In addition, check valves with hammer union connections are available in standard or reverse flow.

The Weir SPM Clapper Style Check Valve is available for both standard service and sour gas (H2S) environments.

Weir SPM's Forged Body Top Load Check Valves are available with traditional hammer union ends or in patented Safety Iron™ end connections.

The check valves are available in pressure ratings from 6,000 to 20,000 psi for well service applications including acidizing, cementing and fracturing. These valves are designed to handle fluids that are heavily laden with materials such as proppants, solids and ball sealers.

Clappers have a coating for high abrasion resistance (HAR) and are manufactured to Weir SPM's stringent Quality Assurance System.

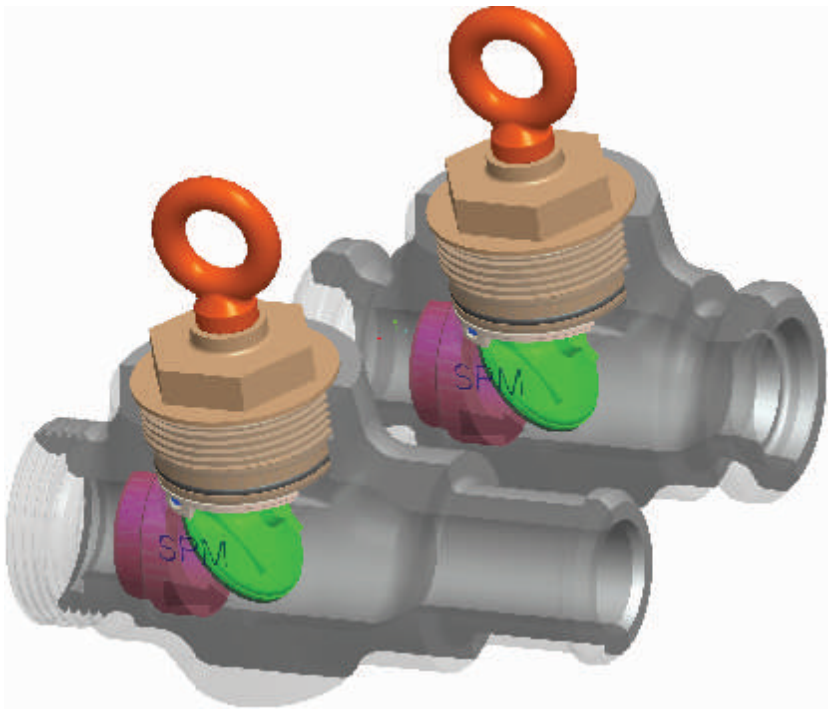

### Benefits seen in the Forged Body Top Load design:

- Seat features increased surface hardness and abrasion resistance.
- Clapper is treated with an abrasion resistant coating to increase durability.
- The stainless steel clapper and hanger exhibit greater corrosion resistance.
- Incorporates a lifting eye to facilitate easier transportation and setup on site.
- Top Load design allows for easy access to internal components without having to remove the valve from the flow line.
- Available in various configurations, including wing-ahead (standard flow) and thread-ahead (reverse flow), and with Safety Iron™ connections.
- Available in a Sour Gas (H2S) version.
- Available in pressure ratings to 20,000 psi and sizes 2" to 4".

### Weir SPM

7601 Wyatt Drive  
Fort Worth  
TX 76108  
USA

Tel: (817) 246 2461  
Fax (817) 246 6324

[www.weiroilandgas.com](http://www.weiroilandgas.com)

